

EASYSYSTEM CLEANING AND MAINTENANCE SCHEDULE

Each Shift – General Cleaning

(When using air to clean out components, make sure that booth exhauster is running and the air is clean, dry and free of oil).

1. Clean the gun nozzle externally with compressed air.
2. Remove hose from injector, clean connector and insert with compressed air and check for wear.
3. Clean the injector housing with compressed air.

Once a Week – Cleaning and Maintenance

Remove EasyFlow injectors and clean thoroughly.

- a. Disassemble injectors and clean with brush.
- b. Check connector and insert for wear.
- c. Replace powder hose if worn or impacted.

Remove EasySelect gun and disassemble spray nozzle.

- a. Clean inside the spray nozzle with compressed air.
- b. Remove any impacted powder.
- c. Check for wear.
- d. Replace electrode holder if wedge is worn unevenly.
- e. Replace flat jet nozzle if there are deep grooves in the slot, if the wall thickness is no longer recognizable, or if the spray pattern is no longer a regular oval shape.

Note: *When reassembling, make sure sleeves are tight on guns.*

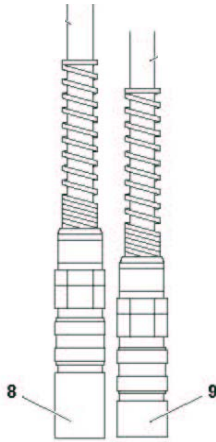

EasyFlow Pump

Item	Description	Part No.
3	Insert Sleeve, Teflon	377724*
4	Hose Connector	377716*
5	Threaded Sleeve	377708
6	Check Valve, Conveying Air	261211
6.1	Check Valve Rebuild Kit	114886
6.2	Check Valve Rebuild Kit	114886
7	Check Valve, Supplementary Air	261203
8	QD Connector, Conveying	261645
9	QD Connector, Supplementary	261637

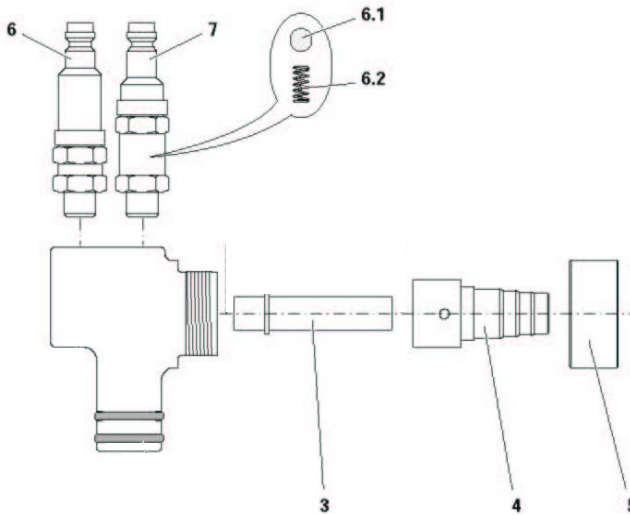

EasyTronic Control Unit

Description	Part No.
LED	260800
Drive Unit	380555
Fuse, 4A, 110V	262897
PC Board	374059

* Denotes wear items. Items listed are those that may be kept for backup for an emergency.

Parts Identification and Suggested Spare Parts List



Nozzles

Item	Description	Part No.
1	Electrode Holder, Flat Jet	379140*
2	Nozzle, Flat Jet	377856*
3	Threaded Sleeve	379166
5	O-Ring	231606*
6	Round Jet Nozzle	378518*
7	Deflector - 16 mm	107210*
	Deflector - 24 mm	107209*
	Deflector - 32 mm	107208*
8	Extension - 150 mm	378852*
	Extension - 300 mm	378860*
9	Electrode Holder, Round Jet	382914*

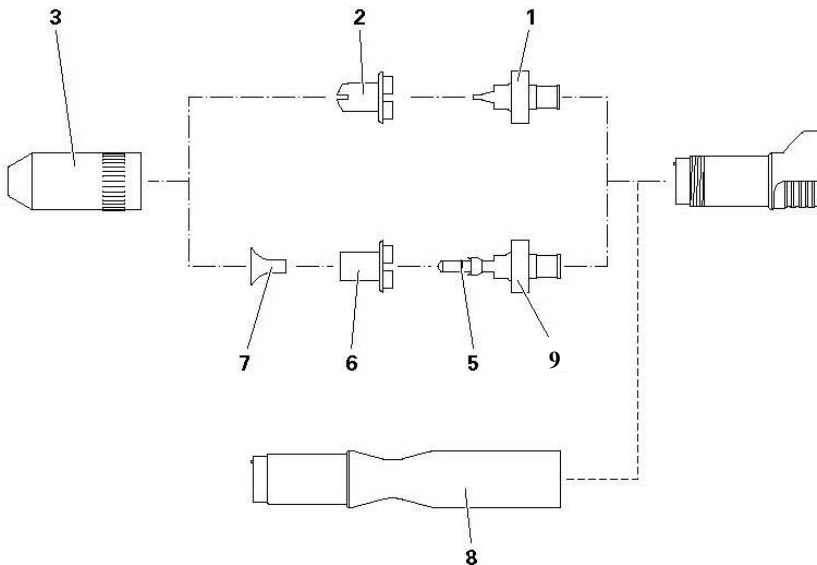

EasySelect Gun

Description	Part No.
Cable Assembly, 6 m	378232*
Powder Tube, Horizontal	378585*
O-Ring, Horizontal Powder Tube	261580*
O-Ring, Vertical Powder Tube	261564*
Hose Connector	377988
Powder Hose	103128*

* Denotes wear items. Items listed are those that may be kept for backup for an emergency.

EASYSYSTEM TROUBLESHOOTING GUIDE

CONDITION	CHECK	SOLUTION
LED 5 illuminated red	<ul style="list-style-type: none"> • The gun is not connected • Gun plug, gun cable or cable connection defect 	<ul style="list-style-type: none"> • Connect the gun • Replace corresponding part or send for repair • Replace remote control (gun cover)
LED 6 illuminated red	<ul style="list-style-type: none"> • Solenoid valve for rinsing air of flat jet nozzle faulty 	<ul style="list-style-type: none"> • Replace solenoid valve spool
LED 7 illuminated red	<ul style="list-style-type: none"> • Solenoid valve for rinsing air of round jet nozzle faulty 	<ul style="list-style-type: none"> • Replace solenoid valve spool
LED 8 remains dark when gun trigger is pulled and LED 5 is green	<ul style="list-style-type: none"> • Gun plug, gun cable, gun cable connection or reed switch defect 	<ul style="list-style-type: none"> • Replace corresponding part or send for repair
Gun LED remains dark when gun trigger pulled and LED 8 is red	<ul style="list-style-type: none"> • Gun plug, gun cable, or gun cable connection defect • Remote control on gun faulty 	<ul style="list-style-type: none"> • Replace corresponding part or send for repair • Replace remote control (gun cover) • Set application mode
Powder not adhering to the part when trigger is pulled, powder is sprayed and LED 8 and gun LED illuminate	<ul style="list-style-type: none"> • High voltage and current deactivated • High voltage cascade faulty • Part poorly grounded 	<ul style="list-style-type: none"> • Set application mode • Send in gun for repair • Check all grounding

Your local Authorized Gema Distributor is: